

R. 11 E. R. 12 E.

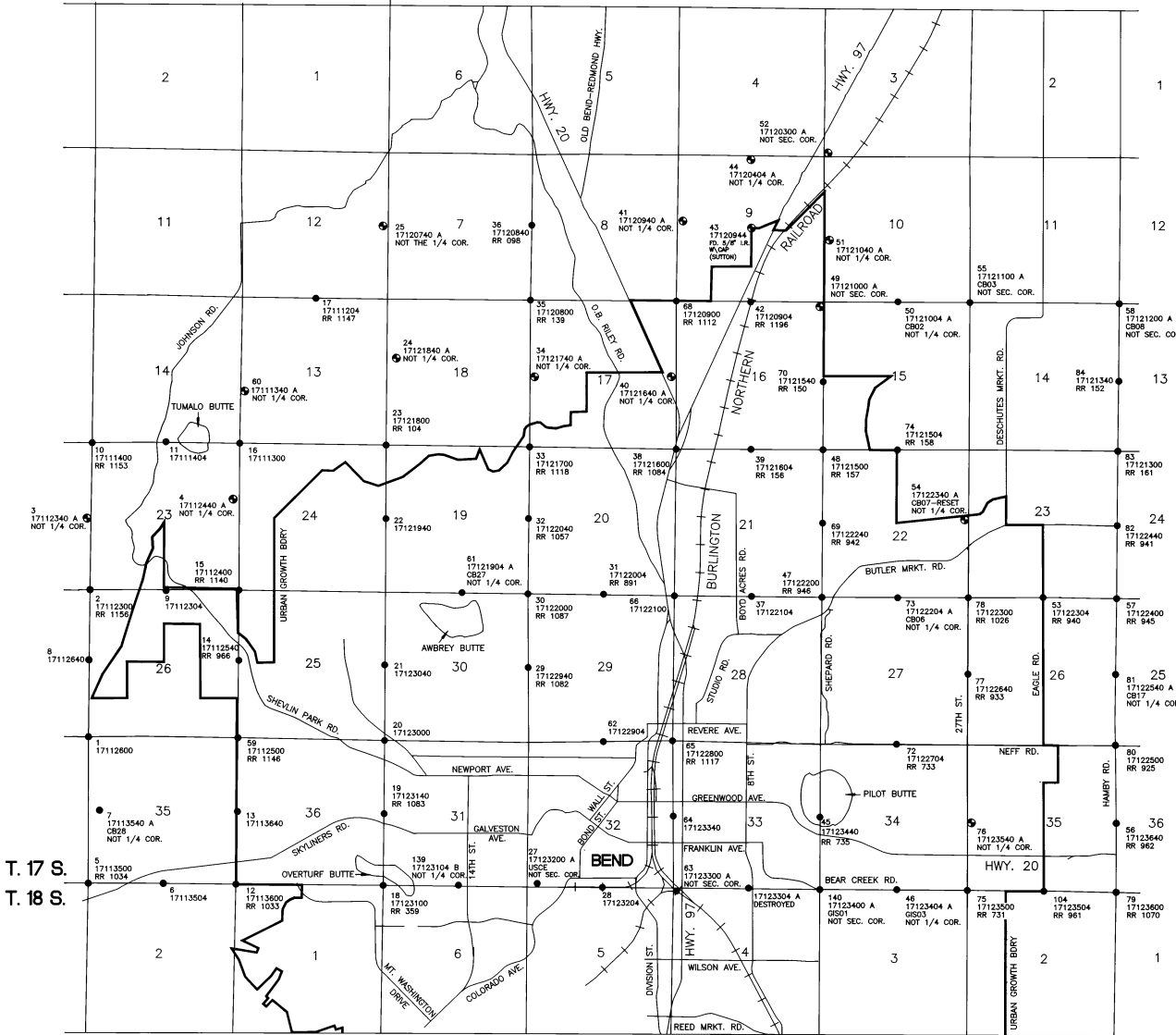

**COUNTY GRID COORDINATE LIST**

PT	NORTHING	EASTING	ELEVATION
3	396473.4012	3273627.3981	3691.09
4	397013.1279	3278635.9294	3537.86
17	404437.5504	3281805.6157	3469.28
24	402680.3731	3284731.1056	3487.83
25	407020.3279	3284218.2373	3490.49
34	401833.3483	3289638.0569	3533.32
40	401764.5958	3294558.2732	3499.03
41	407205.4128	3295074.3442	3459.40
43	407024.5275	3297272.6845	3436.90
44	409400.1563	3297316.5615	3409.82
49	404291.0962	3299838.1447	3460.59
51	406787.5436	3299917.5741	3432.00
52	409680.9843	3299897.0733	3375.61
54	396486.0899	3305121.4323	3478.72
60	401185.0930	3278876.7153	3572.81
76	385850.0676	3305176.0769	3609.95

DESCHUTES COUNTY SURVEYOR  
 FILED 11-23-94 BY J.C.C.

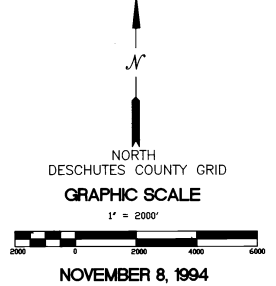

**SURVEYOR'S NARRATIVE**

THE PURPOSE OF THIS SURVEY WAS TO ESTABLISH CONTROL FOR AERIAL MAPPING OF THE BEND URBAN GROWTH BOUNDARY TO AID IN THE DEVELOPMENT OF A SEWER AND WATER MASTER PLAN.

THE BASIS OF THIS MAP IS THE OREGON DEPARTMENT OF TRANSPORTATION MAP FOR THE BEND AREA, OBTAINED ON DISK.

COORDINATES OF THE NEW POINTS ESTABLISHED WERE GENERATED BY FIELD TRAVERSE, USING A WILD TC 1000u TOTAL STATION THEODOLITE. ORTHOMETRIC HEIGHTS WERE DETERMINED BY TRIGONOMETRIC LEVELING.

HORIZONTAL CONTROL DATUM IS NAD (83-91). THE COORDINATE SYSTEM IS A USER-DEFINED TRANSVERSE MERCATOR AND THE ZONE IS THE DESCHUTES COUNTY GRID IN INTERNATIONAL FEET. THE VERTICAL CONTROL DATUM IS IN U.S. SURVEY FEET NGVD 29. SEE SEPARATE DESCRIPTION SHEETS FOR EACH POINT SHOWN HEREON, ON FILE WITH THE DESCHUTES COUNTY SURVEYOR.

MONUMENTS ESTABLISHED ARE 1/2" IRON RODS WITH RED PLASTIC CAPS MARKED "KERN CONTROL", EXCEPT WHERE NOTED. SEE SEPARATE DESCRIPTION SHEETS ON FILE WITH THE DESCHUTES COUNTY SURVEYOR.

**LEGEND**

- MONUMENT FOUND AS PER DESCHUTES COUNTY CORNER RESTORATION RECORDS, OR DESCHUTES COUNTY CONTROL SURVEY RECORDS
- SET 1/2" IRON ROD WITH RED PLASTIC CAP MARKED "KERN CONTROL", EXCEPT WHERE NOTED
- RR DESCHUTES COUNTY CORNER RESTORATION NUMBER, DESCHUTES COUNTY SURVEYOR'S OFFICE
- URBAN GROWTH BOUNDARY

**CONTROL SURVEY  
 FOR THE CITY OF BEND  
 NORTH AREA  
 LOCATED IN T. 17 S., T. 18 S., R. 11 E., R. 12 E., W.M.  
 DESCHUTES COUNTY, OREGON**

PREPARED BY:  
 KERN LAND ASSOCIATES, INC.  
 PROFESSIONAL LAND SURVEYORS  
 1030 NW NEWPORT AVENUE  
 BEND, OREGON 97701  
 (503) 389-4756

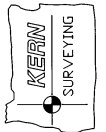

REGISTERED  
 PROFESSIONAL  
 LAND SURVEYOR  
 Jeff Kern  
 11/23/94  
 LEFFNER & KERN  
 S.P.S.